



SAVANNAH COURT, DEATSVILLE, AL

\$319,900 2001 SF 4 Bedrooms 2 Bathrooms 2 Car Garage

\$0 DOWN FINANCING AVAILABLE

FEATURES

- Separate Dining Room
- 10' Ceiling in Family Room
- 9' Ceilings throughout
- Wood Burning Fireplace
- Eat-in Kitchen with Breakfast Bar & Breakfast Nook
- Separate Garden Tub & Large Shower in Master Bath
- 2 Large Walk-in Closets & Double Vanities in Master
- Raised Vanities
- Luxury Vinyl Plank in all Common Areas
- Hard Tile in Foyer, Fireplace & Bath
- Architectural Roof
- Two Separate Attic Accesses from Inside Hall & Garage
- Centrally Wired Command Center
- Side Loading Garage
- Garage Door Openers
- Ceiling Fans in Master & Great Room
- Spray Foam Insulation in All Exterior Walls & Roof Line
- Energy Saving Heat Pump Hot Water Heater
- Energy STAR Appliances & Fans

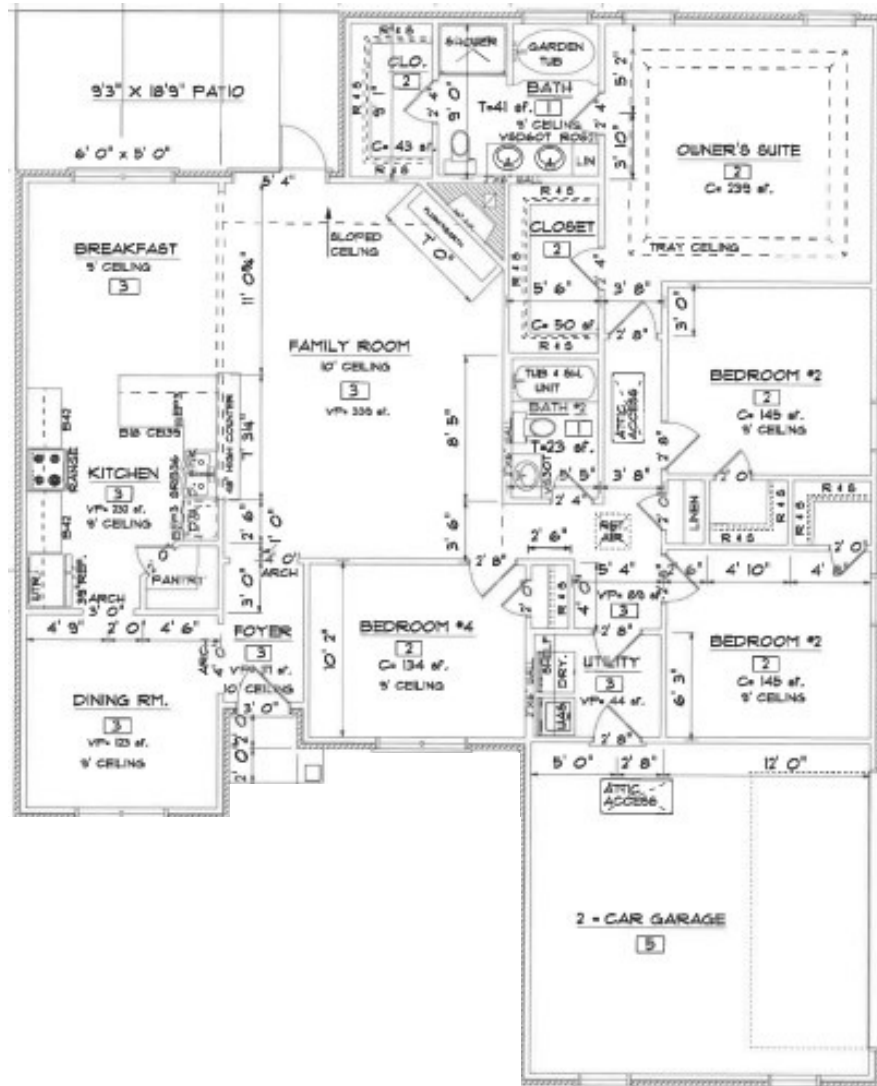

CONTACT US TO LEARN MORE



GOODWYN BUILDING CO.

Montgomery's Hometown Builder

WHY WOULD YOU WANT AN ENERGY EFFICIENT HOME?

AVERAGE MONTHLY HEATING & COOLING COSTS
\$53



You'll see the differences every day in your new energy-efficient home by **Goodwyn Building**.

- Reduced energy bills
- Healthier indoor air
- Increased value
- Reduced reliance on natural resources
- Lower greenhouse gas output

Goodwyn Building has a set of standards to ensure that your home is the most energy-efficient and high-performance home around including:

- Matched HVAC Equipment
- 14.3 SEER Electric Air-to-Air Heat Pump
- R-4.2 ductwork located in conditioned space
- 6" open-cell sprayed foam roof deck insulation and 3.5" open-cell sprayed foam exterior walls
- Slab floor
- Double pane Low-E vinyl windows
- Metal poly-core French and solid-core doors.



Goodwyn Building homes are substantially more energy-efficient than homes built to the minimum code requirements. **Goodwyn Building** can build your dream home that is perfect for your budget and your lifestyle.

CONTACT US TO LEARN MORE

